

Project Information: **Landfills**

Your contact person: Mr. Hardy L. Rückert, Senior Geographer



For the remedial of old deposits and landfills we prepare Geological and Hydrological pre-studies, expose alternatives of design and costs, we plan the restoration, create the service specification and call for bids.

We attend and survey the restoration work and we monitor after completion.

Project Examples:

Landfill Remedial By Capping And Partial Vertical Sealing, Bamberg, 1997 - 1998

Customer: City of Bamberg

Expenses: about 2 Million €

Horizontal components of the sealing system:

- Geosynthetic Drainage Liner
 - PEHD-Liner
 - Geosynthetic Clay Liner (GCL)
- Laid on 12.000 m² / 14.400 sq yards.

Vertical sealing with bentonite amended clay.

The run-off rain water had to be channeled underneath a 4 lane road.

Specific feature:

On top of the capped landfill, a parking-lot for park & ride service was established.

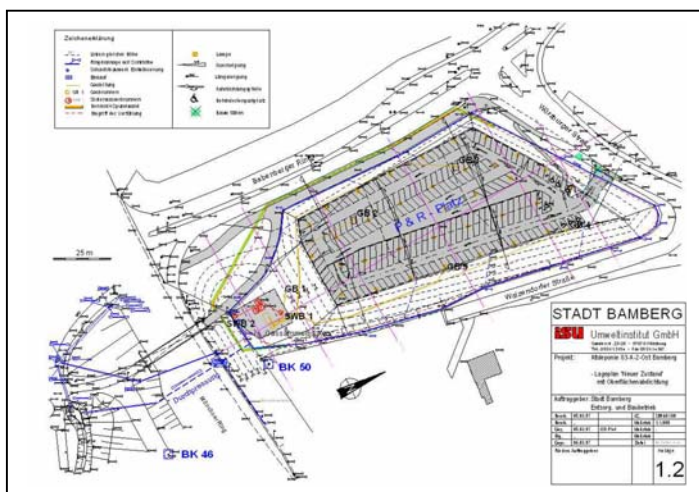

Plan dispatch

Landfill body extending below private property



Preservation of an arbor



Address
isu umweltinstitut GmbH
Sanderstraße 23-25
97070 Würzburg
Germany

Phone 0(49) 931 13194
Mobile 0(49) 172 3703063
Facsimile 0(49) 931 14367

Banking Account
Sparkasse Mainfranken Würzburg
BLZ 790 500 00
No. 42 232 538

Executive Secretaries:
Dipl. Geol. M. Appel
Dipl. Geogr. H. Rückert
HRB Würzburg 2918

Remedial Design For The Gaustadt Landfill, Bamberg, 2002 - 2004

Customer: City of Bamberg

Estimated remediation costs: 1.6 millions €

isu performed extended geological and hydrological studies resulting a groundwater filling inside the landfill body. A pumping test ran over a half year to evaluate the assumptions.

It is planned to cap the landfill with a sealing system showed in this picture →

Currently special firms are invited to bid nationwide.

Special technical features are:

Insertion of drainage pipes to channel wastewater outside the landfill body.

The plan section shows the inserted drain pipe system →

Regelschnitt 'Oberflächenabdeckung'

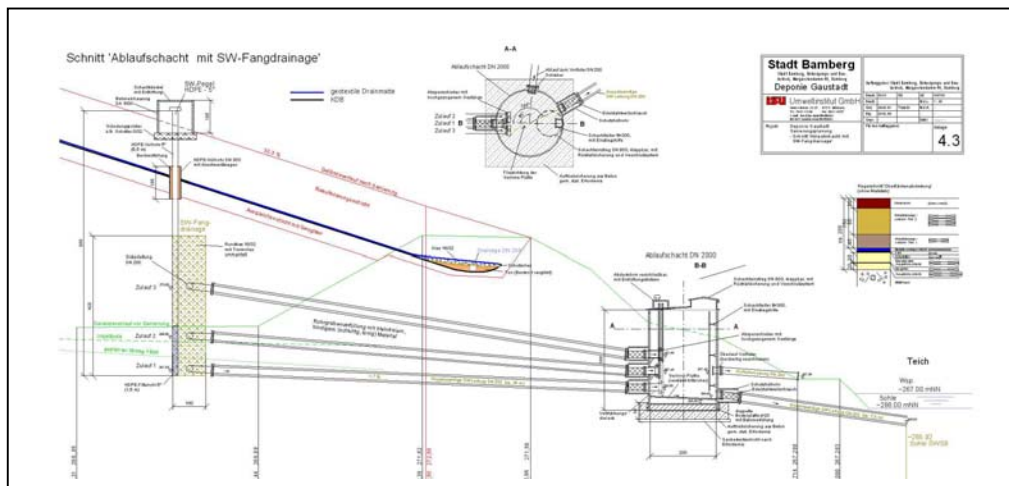
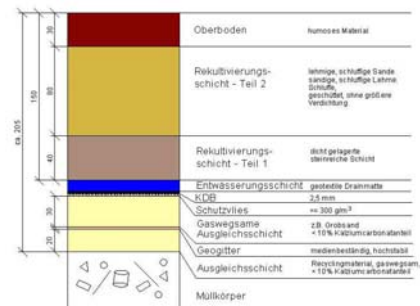

Projects On Landfill Gas Treatment



A PEHD-gas well ready to plug in

Passive venting system with bio-filter



Gas drains merged at the central control bar

Landfill gas flare



We also gage the gas components on site:



Address
isu umweltinstitut GmbH
Sanderstraße 23-25
97070 Würzburg
Germany

Phone 0(49) 931 13194
Mobile 0(49) 172 3703063
Facsimile 0(49) 931 14367

Banking Account
Sparkasse Mainfranken Würzburg
BLZ 790 500 00
No. 42 232 538

Executive Secretaries:
Dipl. Geol. M. Appel
Dipl. Geogr. H. Rückert
HRB Würzburg 2918

e-mail: info@isu-umweltinstitut.de +++ internet: www.isu-umweltinstitut.de